

# FUTEK MODEL MTA500 (L2905)

# LOW PROFILE THRUST AND MOMENT LOAD CELL

**Drawing Number: FI1008-B**

**INCH [mm] | R.O.= Rated Output**

WIRING CODE (CC1)

+Excitation	-Excitation	+Signal	-Signal
RED PIN 'A'	BLACK PIN 'B'	GREEN PIN 'C'	WHITE PIN 'D'
+Sense	-Sense		
ORANGE PIN 'E'	BLUE PIN 'F'		

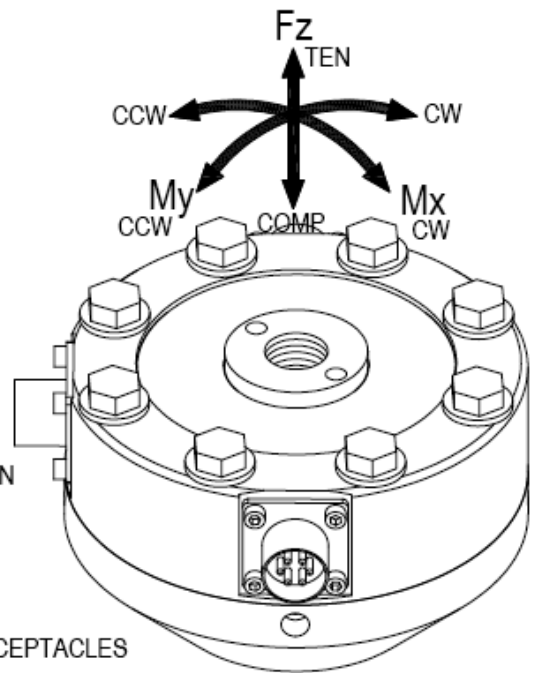
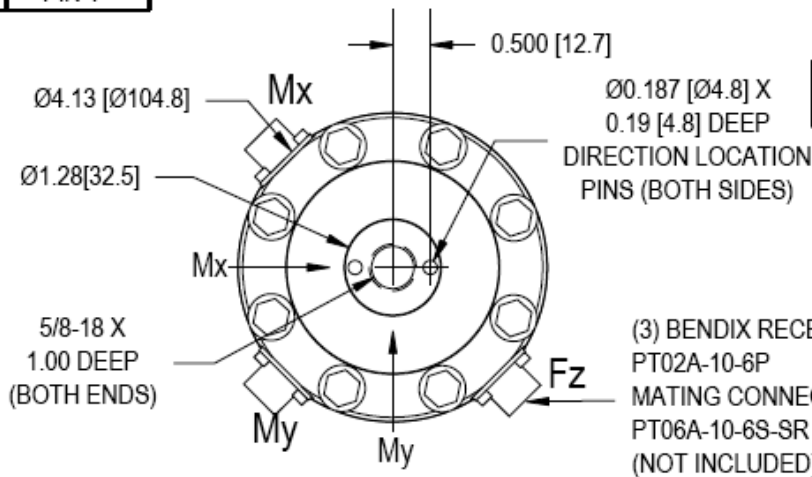

TEN=TENSION (+OUTPUT)  
 COMP=COMPRESSION (-OUTPUT)  
 CW=CLOCKWISE (+OUTPUT)  
 CCW=COUNTER CLOCKWISE (-OUTPUT)

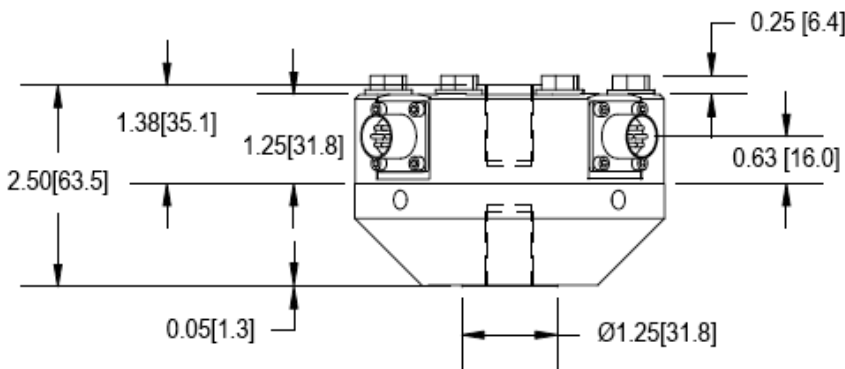

## SPECIFICATIONS:

<b>RATED OUTPUT</b>	1 mV/V nom.
<b>CAPACITY</b>	SEE CHART
<b>SAFE OVERLOAD</b>	150% of R.O.
<b>ZERO BALANCE</b>	±2% of R.O.
<b>EXCITATION (VDC OR VAC)</b>	18 MAX
<b>BRIDGE RESISTANCE</b>	350/700Ω nom.
<b>NONLINEARITY (Mx, My)</b>	±0.5% of R.O.
<b>NONLINEARITY (Fz)</b>	±0.2% of R.O.
<b>CROSS TALK</b>	±2% of R.O. OR LESS
<b>TEMP. SHIFT ZERO</b>	±0.01% of R.O./°F (0.018% of R.O./°C)
<b>TEMP. SHIFT SPAN</b>	±0.01% of LOAD/°F (0.018% of LOAD/°C)
<b>COMPENSATED TEMP.</b>	60 to 160°F (15 to 72°C)
<b>OPERATING TEMP.</b>	-60 to 200°F (-50 to 93°C)
<b>MATERIAL</b>	SEE CHART
<b>CONNECTOR:</b>	(3) 6 Pin BENDIX Receptacle (PT02A-10-6P)
<b>ACCESSORIES AND RELATED INSTRUMENTS AVAILABLE</b>	
<b>CALIBRATION (STD)</b>	5 pt. COMPRESSION, CW ; 100 KΩ SHUNT CAL. VALUE
<b>CALIBRATION (OPTIONAL)</b>	5 pt. TENSION, CCW
<b>CALIBRATION TEST EXCITATION</b>	10 VDC

STOCK#	CAPACITY		MATERIAL
	lb (Fz)	in-lb (Mx, My)	
FSH02505	1000	400	ALUMINUM
FSH01929	2000	800	17-4 S.S.
FSH02299	5000	1000	
FSH02453	10000	2000	

**FUTEK**  
 ADVANCED SENSOR TECHNOLOGY, INC.

This drawing is submitted solely for the information and exclusive use of the original addressee. It is not to be divulged in whole or in part, by any firm or individual without written permission from FUTEK

CAGE CODE # 1X8M6

10 THOMAS  
 IRVINE, CA 92618 USA  
 1-800-23-FUTEK (38835)