

# FUTEK MODEL TAT300

**Drawing Number: FI1140-A**

**INCH [mm] R.O.= Rated Output**

**WIRING CODE (WC4)**

+Excitation	-Excitation	+Signal	-Signal
RED	BLACK	GREEN	WHITE

+Sense	-Sense	Shield
ORANGE	BLUE	Grounded

# Reaction Torque Sensor – Screw Driver

(Previously T5165) w/ 1/16-3/8 DIA. CHUCK

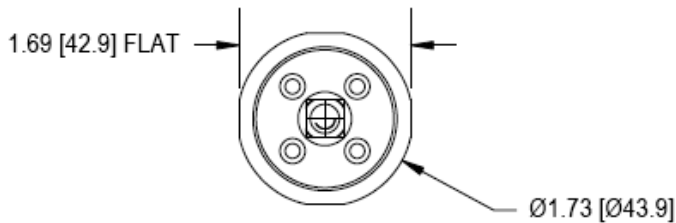
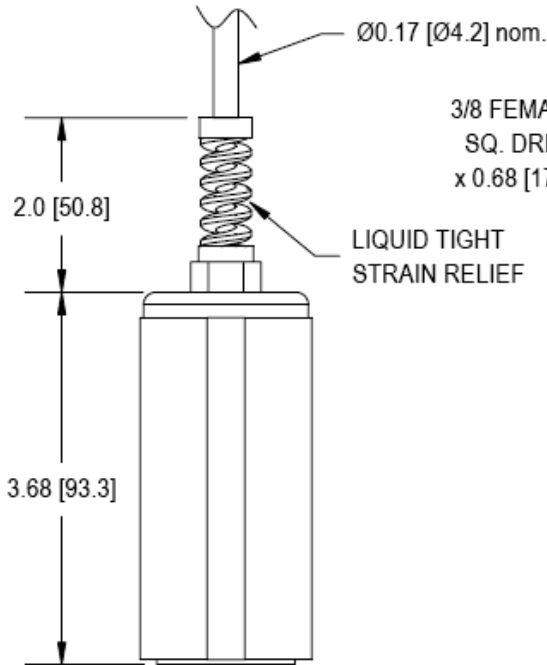
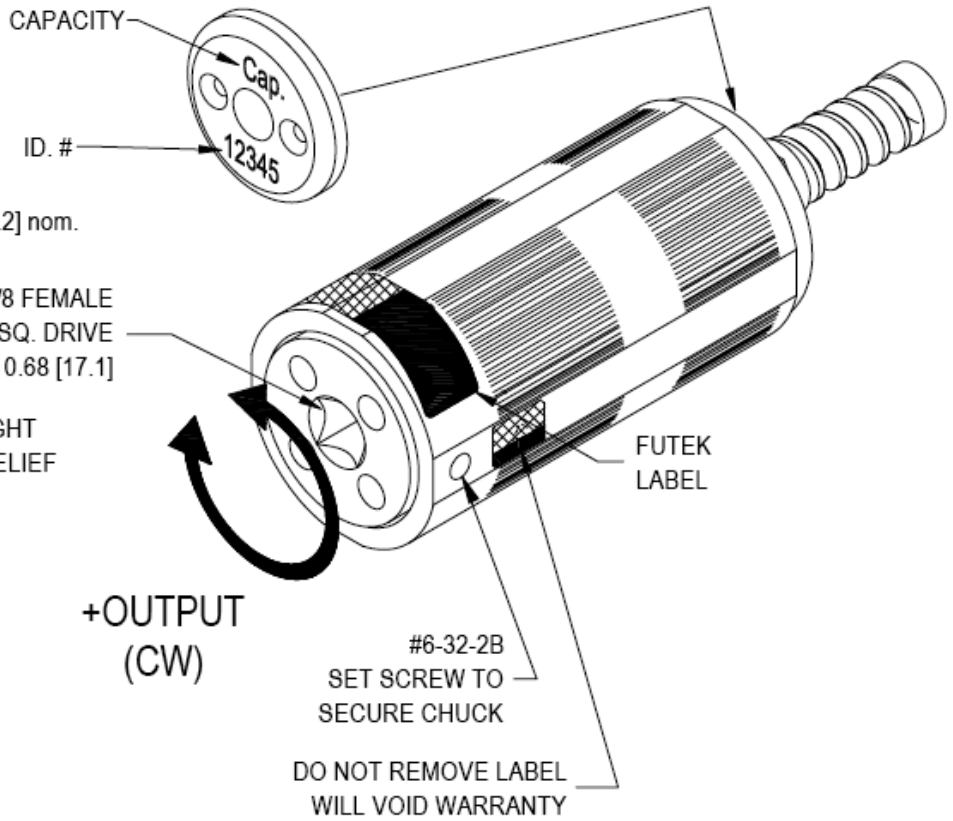

STK#	CAPACITY		TORSIONAL STIFFNESS
FSH00622	50 in-oz*	300 mNm	3300 in-oz/rad
FSH00623	12 in-lb*	1.5 Nm	1000 in-lb/rad
FSH00624	50 in-lb	6 Nm	9400 in-lb/rad
FSH00625	100 in-lb	12 Nm	13200 in-lb/rad

\*with Overload Protection

## REMOVABLE CHUCK ASSEMBLY

STOCK# FSH00619 - 1/16-3/8 DIA. CHUCK  
6.3 oz [179 g] (INCLUDED)

STOCK# FSH00618 - 5/64 -1/2 DIA. CHUCK  
12.1 oz [343 g] (NOT INCLUDED)

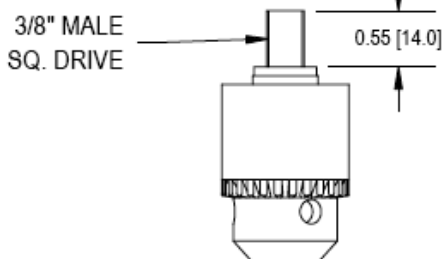

## SPECIFICATIONS:

RATED OUTPUT	2 mV/V nom.
SAFE OVERLOAD	150% of R.O.
ZERO BALANCE	±2% of R.O.
EXCITATION (VDC OR VAC)	18 MAX
BRIDGE RESISTANCE	1000 Ω nom.
NONLINEARITY	±0.2% of R.O.
HYSTERESIS	±0.2% of R.O.
NONREPEATABILITY	±0.05% of R.O.
TEMP. SHIFT ZERO	±0.002% of R.O./°F [0.0036% of R.O./°C]
TEMP. SHIFT SPAN	±0.002% of LOAD/°F [0.0036% of LOAD/°C]
COMPENSATED TEMP.	60 to 160 °F [15 to 72 °C]
OPERATING TEMP.	-40 to 180 °F [-40 to 82 °C]
WEIGHT	11 oz [312 g] WITHOUT CHUCK
MATERIAL	BLACK ANODIZED ALUMINUM
CABLE: #28 AWG, 6 Conductor, Retractable PVC Cable 10 ft [3 m] Long Extended	
<b>ACCESSORIES AND RELATED INSTRUMENTS AVAILABLE</b>	
CALIBRATION (STD)	5 pt. CW; 150KΩ SHUNT CAL VALUE
CALIBRATION (OPT)	5pt. CCW
CALIBRATION TEST EXCITATION	10 VDC

系泰機電有限公司

Tel : (04)2706-9659  
Fax: (04)2452-0110

[www.accusystem.com](http://www.accusystem.com)

E-mail: [sales@accusystem.com](mailto:sales@accusystem.com)