

FUTEK MODEL TDD400

SQUARE DRIVE TO SQUARE DRIVE REACTION TORQUE SENSOR (Previously T5103)

Drawing Number: FI1135-A

INCH [mm] | R.O.= Rated Output

WIRING CODE (CC4)			
+Excitation	-Excitation	+Signal	-Signal
1 Red	4 Black	2 Green	3 White

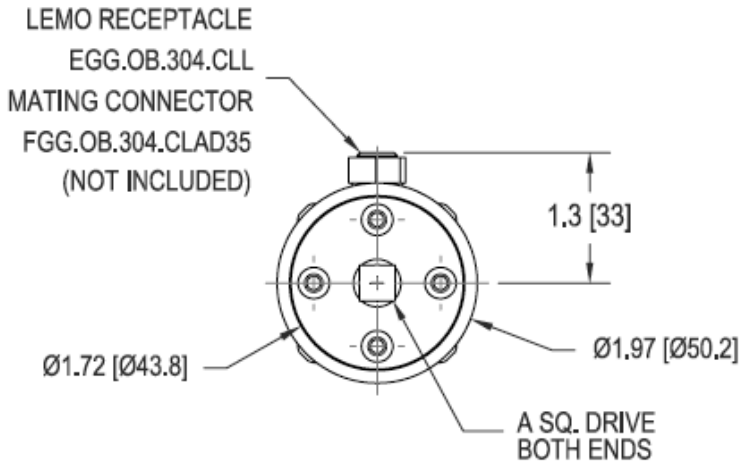
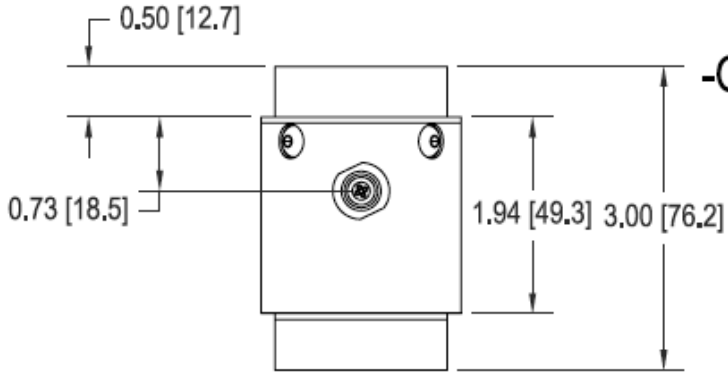
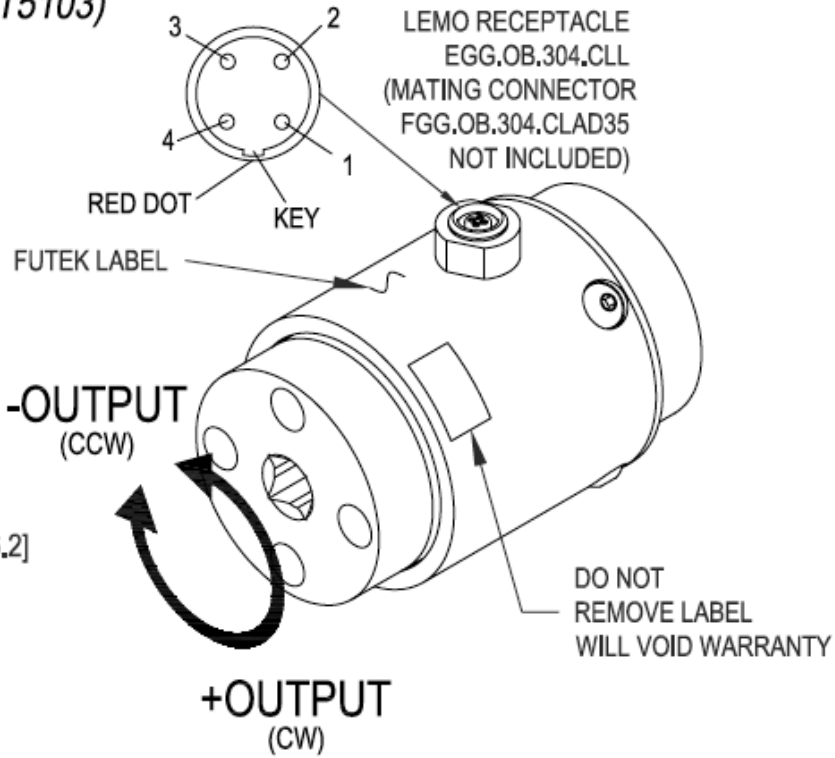

STK#	CAPACITY		A	TORSIONAL STIFFNESS in-oz/rad
	in-oz	Nm		
FSH02779	5*	0.04	1/4"	325
FSH02780	10*	0.08		650
FSH02781	20*	0.15		1600
FSH02782	50*	0.37		3500
FSH02783	100*	0.75		7300
FSH02784	160*	1.2		11000
FSH02785	400*	3.0		30000
FSH02786	1000	7.5		71000
FSH02787	100 in-lb	12	3/8"	77000 in-lb/rad
FSH02788	200 in-lb	24		95000 in-lb/rad
FSH02789	500 in-lb	60		199000 in-lb/rad

* WITH OVERLOAD PROTECTION
FOR HIGHER CAPACITIES REFER TO MODELS TFF600-750
AND TDF600-675

SPECIFICATIONS:

RATED OUTPUT	1 mV/V nom. (5 in-oz) 2 mV/V nom. (10 in-oz to 500 in-lb)
SAFE OVERLOAD	150% of R.O.
ZERO BALANCE	±1% of R.O.
EXCITATION (VDC OR VAC)	18 MAX
BRIDGE RESISTANCE	350 Ω nom. (5 to 1000 in-oz) 700 Ω nom. (100 to 500 in-lb)
NONLINEARITY	±0.2% of R.O.
HYSTERESIS	±0.2% of R.O.
NONREPEATABILITY	±0.05% of R.O.
TEMP. SHIFT ZERO	±0.002% of R.O./°F [0.0036% of R.O./°C]
TEMP. SHIFT SPAN	±0.002% of LOAD/°F [0.0036% of LOAD/°C]
COMPENSATED TEMP.	60 to 160°F [15 to 72°C]
OPERATING TEMP.	-60 to 200°F [-50 to 93°C]
WEIGHT	14 oz [397 g]
MATERIAL	ALUMINUM
CONNECTOR	4 Pin Lemo Receptacle (EGG.OB.304.CLL)
ACCESSORIES AND RELATED INSTRUMENTS AVAILABLE	
CALIBRATION (STD)	5 pt. CW; 60.4KΩ (5 to 1000 in-oz) 100KΩ (100 to 500 in-lb) SHUNT CAL. VALUE
CALIBRATION (OPT)	5pt. CCW
CALIBRATION TEST EXCITATION	10 VDC

系泰機電有限公司

Tel : (04) 2706-9659
Fax : (04) 2452-0110

www.accusystech.com
E-mail: sales@accusystech.com